

INSTALLATION INSTRUCTIONS
CARGO BARRIER
4B57S
FOR THE 2007-2008 CHEVY SUBURBAN



I. Check the illustration below to insure you have all the parts you need for the installation.

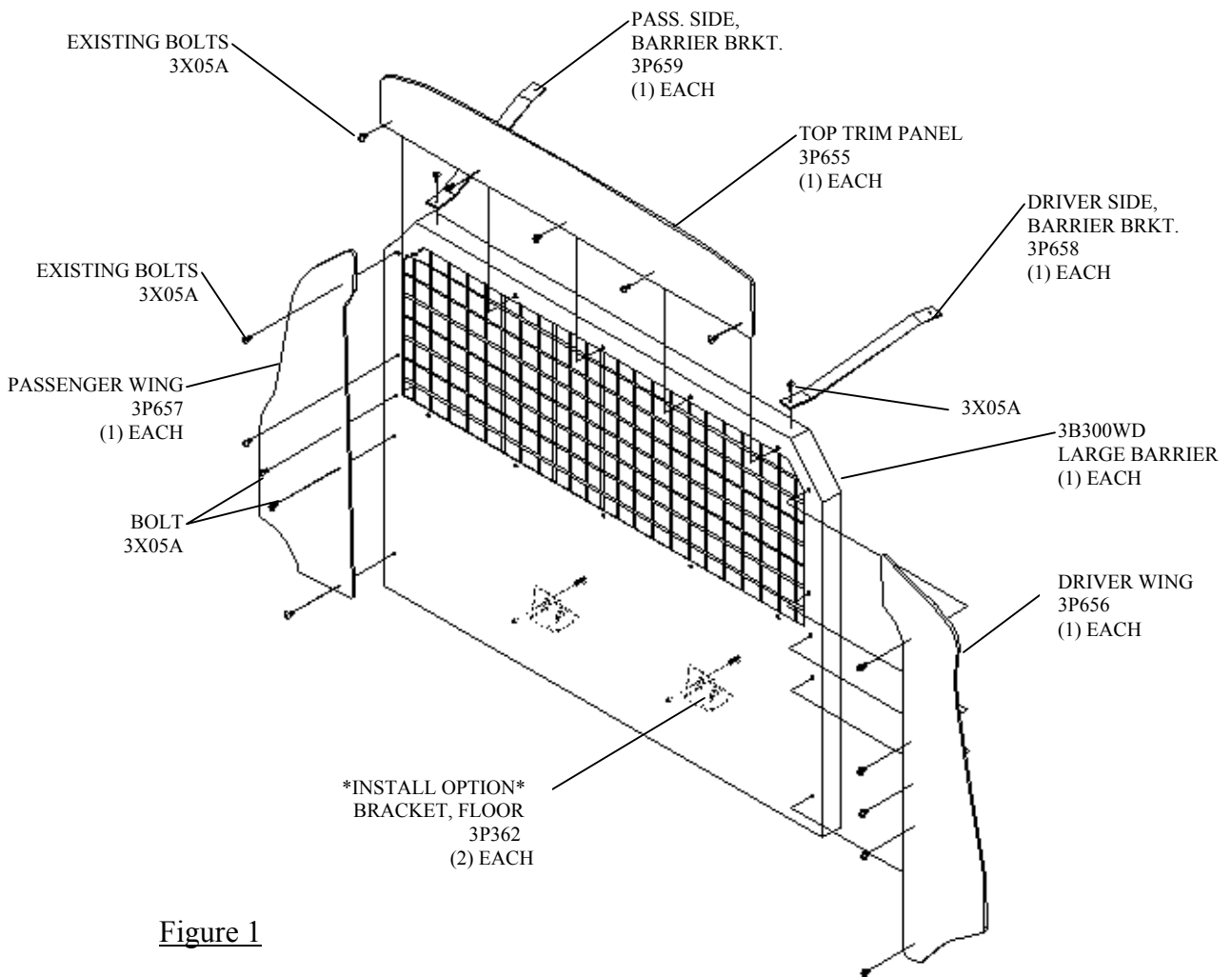
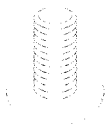
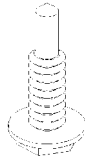

Figure 1



3X05A
1/4-20 X 7/8 PHILLIPS
TRUSS HEAD MS
(15) EACH



3X110
#14 X 1 SLF DRL,
WASHER HD. ZN
(2) EACH

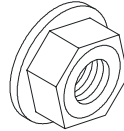

3X16
1/4-20 WHIZ WASHER
HEX NUT
(15) EACH

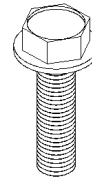

3X139
M6 X 35mm HEX HD.
CAP SCREW
(2) EACH

- II. You will need the following tools:
- Ratchet with 7/16" and 10 or 11 MM Socket.
 - Phillips Screwdriver
 - Drill/driver w/3/8 socket & 5/16" bit

- III. Install the Barrier as follows:
Note: Only snug fasteners until all components are installed.

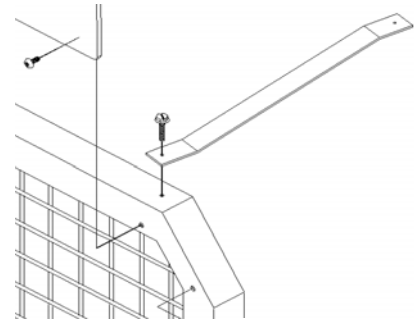

Figure 2

- Install the (3P658 Driver and 3P659 Passenger) mounting brackets to the barrier using the (3X05A) bolts and (3X16) nuts through the holes in the barrier as shown in figure 2.
- Remove the rear hook mechanisms from the ceiling by pulling the hook down. Unscrew and completely remove the rear hook, see figure 3, then remove the screw revealed inside the. Rear of brackets will be secured here later, see figure 4.



Figure 3



Figure 4

- Place the Cargo Barrier Assembly behind the rear seat so the barrier flange and brackets are towards the rear of the vehicle as shown in figure 5 and 6. Note: The barrier should be aligned along the edge of the floor behind the rear seats shown in figure 7.
- Align the rear barrier bracket holes with the hole used to attach the rear hook mechanisms removed earlier. Attach the barrier brackets using the (3X139) M6 bolts and black, plastic spacers (7/8") as shown in figure 4. Be sure to insert the spacer behind the bracket and insert the M6 bolt through both pieces. Do not tighten the bolt completely at this time.



Figure 5



Figure 6

e. Attach the (3P655) Top Trim Panel to the Cargo Barrier by removing the existing bolts from the top of the window, as shown in figure 1.

f. With the top of the barrier located by the top brackets, position the bottom of the barrier is positioned as shown in the following photo. Now place the (3P656 Driver & 3P657 Passenger) Polycarbonate wings against the front of the Cargo Barrier and out to the contour of the b-pillars and windows. When positioned, mark locations of the mounting holes on each wing. Remove the existing hardware and drill 5/16" diameter holes to allow a little clearance to aid in installation. Reposition and attach the wings using 1/4" (3x05A) bolts and (3x16) nuts.

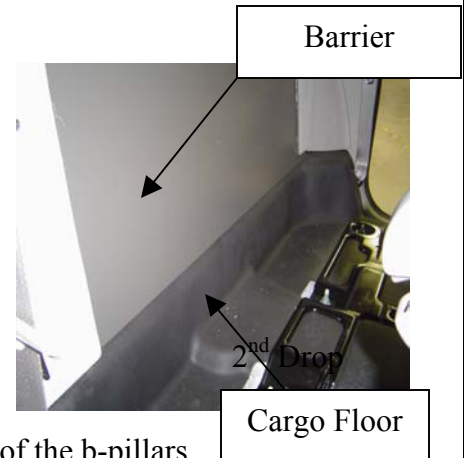

Figure 7

g. With the Cargo Barrier and wings attached and positioned correctly, attach the barrier to the floor using 2 self-drilling screws into the floor only or using the optional (3P362) brackets and self-drilling screws as shown in figure 8. Drill 2 screws through the slots in the bracket into the barrier and 2 screws through the slots in the bracket into the floor.

h. Once you have installed the barrier correctly, tighten all bolts.

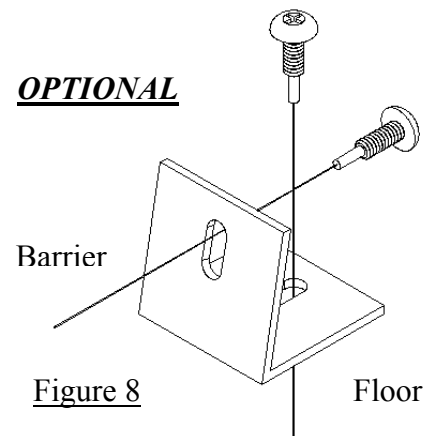

Figure 8



[IF THERE ARE ANY QUESTIONS OR CONCERNS PLEASE CONTACT:](#)

PRO-GARD PRODUCTS, LLC

Phone: 317-579-6680

Fax: 317-579-6681