

**INSTALLATION GUIDE**  
STANDARD PARTITION  
FORD CROWN VICTORIA

**Pro-gard**<sup>™</sup>  
PRODUCTS LLC.

STRONG | RELIABLE | SECURE

**pro-gard.com**  
**800.480.6680**

THESE COMPONENTS ARE REQUIRED  
TO INSTALL THE PRO-GARD PARTITION SYSTEM

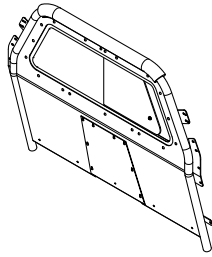

P2600 SERIES  
STANDARD PARTITION

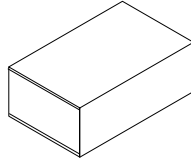

4P23FD  
HARDWARE KIT

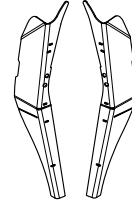

4W26D / 4W26P  
WING KIT

**I. Refer to the parts list below to be sure all components were received in the 4P23FD mounting kit.**

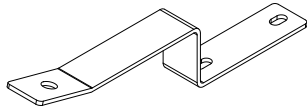

Seat Mount Bracket  
3P217  
2 Req'd

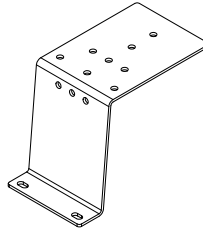

Lower Mount  
3P213  
2 Req'd

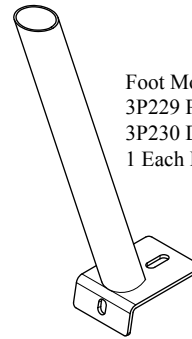

Foot Mount  
3P229 Passenger  
3P230 Driver  
1 Each Req'd

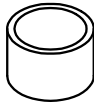

Spacer-1"  
3P542  
2 Req'd

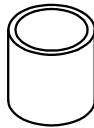

Spacer-1-1/2"  
3P5415  
2 Req'd

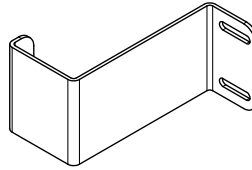

B-pillar Bracket, Front  
3P430  
2 Req'd

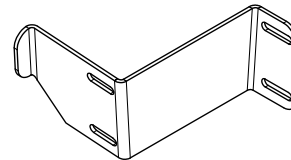

B-pillar Bracket, Rear  
3P344X Passenger  
3P345X Driver  
1 Each Req'd

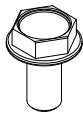

5/16-12 x 5/8 HWH  
"B" Machine Screw  
3X26  
4 Req'd

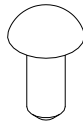

1/4-20 x 5/8  
Carriage Bolt  
3X36  
14 Req'd



1/4-20 x 3/4  
Carriage Bolt  
3X61  
8 Req'd

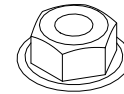

1/4-20 Hex  
Whiz Nut  
3X16Z  
22 Req'd

**II. Tools Required:**

7/16" combination wrench or socket wrench (1/4" drive is adequate)  
1/2" combination wrench or socket wrench (3/8" drive preferred)

**III. Read all instructions carefully before beginning the installation process.**

**IV. Installing the partition.**

- A. Assemble the 3P229 Passenger Mounting Foot to the 3P213 Mounting Plate using the 3X26 (5/16-12 x 5/8) Self threading Bolts. Repeat for Driver's side assembly. (See fig. 1)
- B. Attach the 3P217 Seat Mount Bracket to each assembly using two 3X36 (1/4-20 x 5/8) Carriage bolts and 3X16Z Whiz nuts. Tighten all fasteners. (See fig. 1)
- C. Move the front seats all the way forward. At the rear of each front seat remove the outer OEM seat mounting nut and washer and keep close for reinstallation. (See fig. 1)

FIG. 1

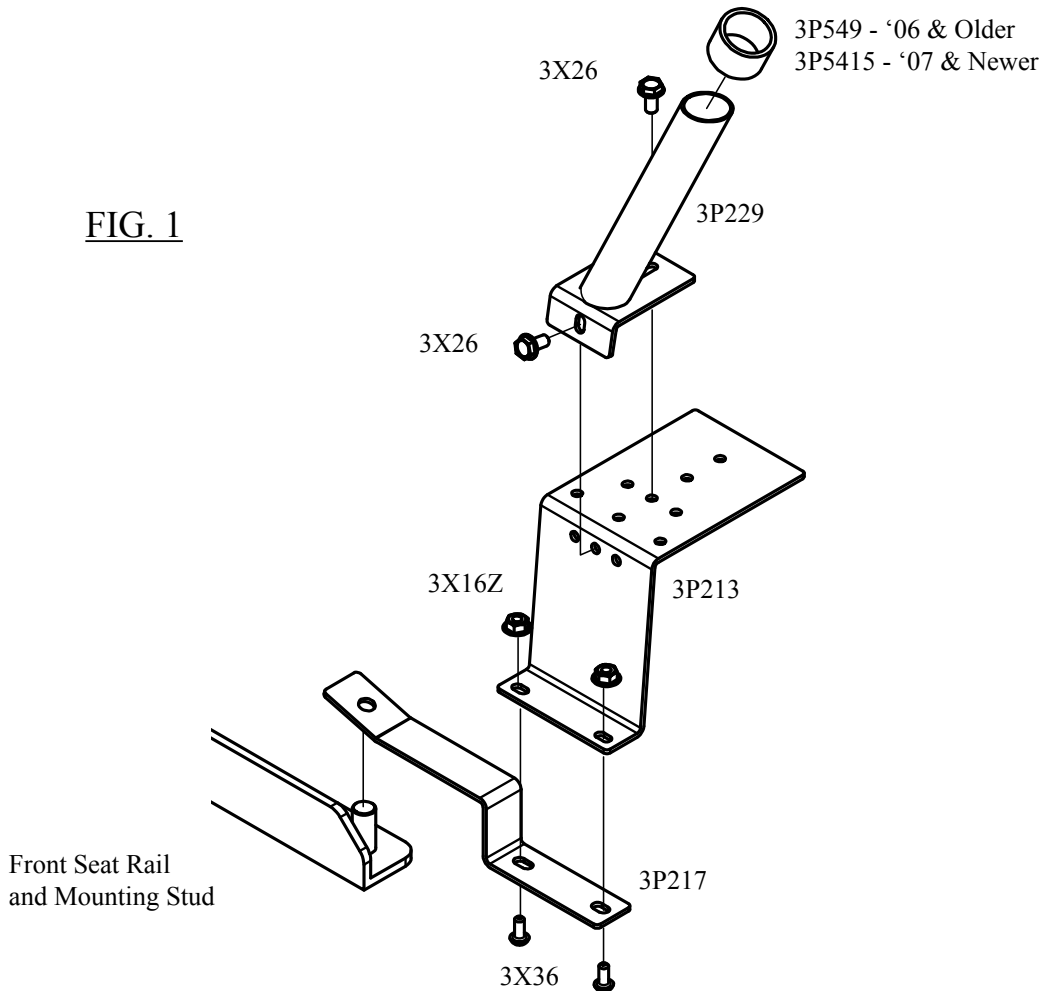

- D. Slide the proper PVC Spacer over the pipe on each Mounting Foot. (1" for '06 and older or 1-1/2" for '07 and newer) Place each of these assemblies in the foot well of the rear seat with the tube portion pointing up and angling toward the rear of the car. Slide the hole in the Seat Mounting Bracket down over the seat mounting stud. (See fig. 1) Make sure the outer edge of the 3P213 bracket slides under the bottom of the b-pillar trim.
- E. If a Pro-gard Floor Pan is being used, install it now, making sure it slides under the b-pillar and door trim at both sides.
- F. Place the partition in the rear seat of the vehicle with the window frame assembly facing up.

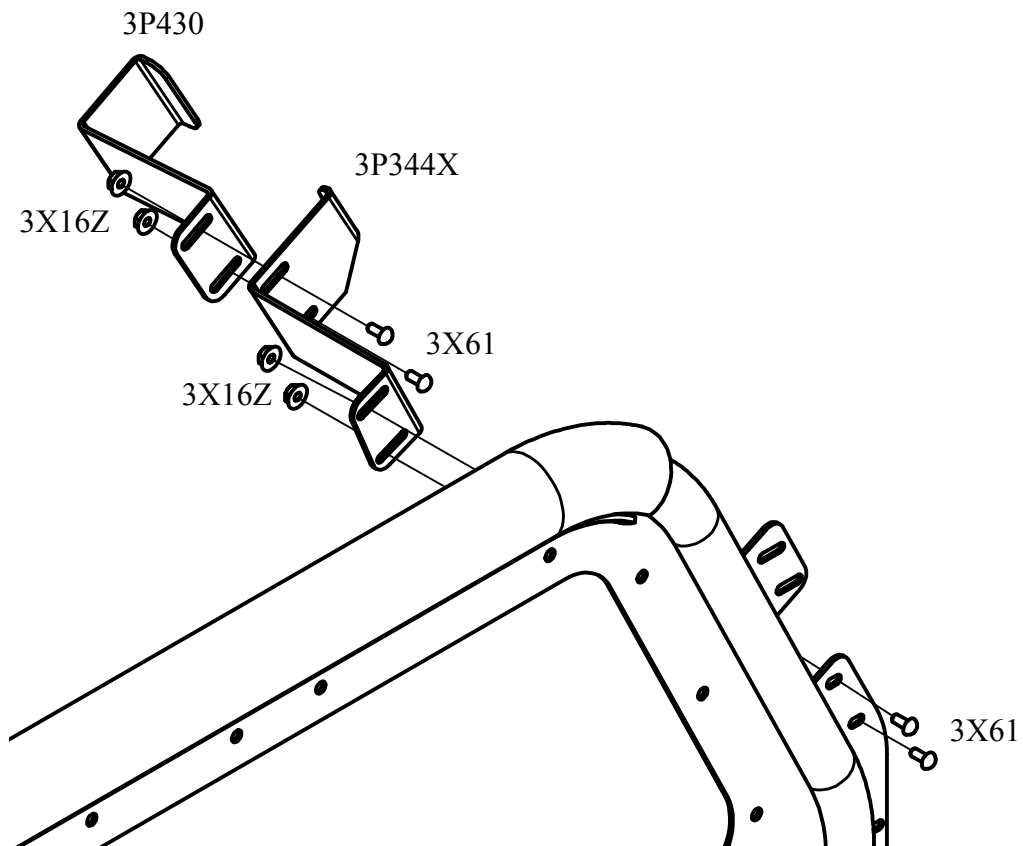
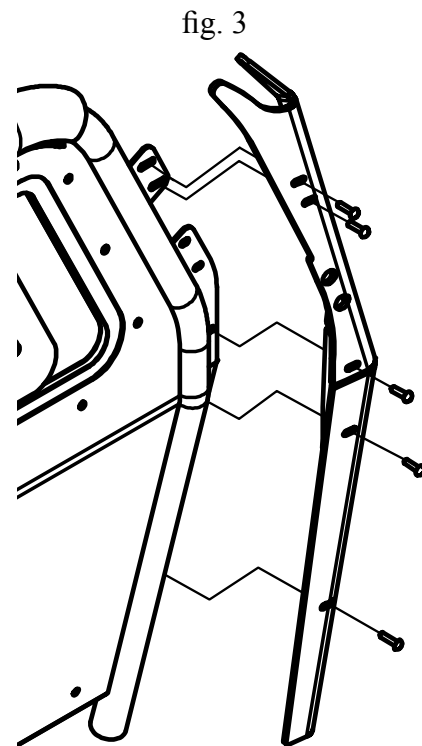

FIG. 2

- G. Attach the 3P344X Passenger side and 3P345X Driver side B-pillar Brackets to the top two holes of the wide middle tab at each side of the partition using two 3X61 (1/4-20 x 3/4) carriage bolts and 3X16Z Whiz nuts. Leave loose so the brackets will still move. (See fig. 2)
- H. With the help of another person, align the ends of the roll bar portion of the partition with the tube portion of the foot mounting assemblies. Rotate the partition up into a vertical position so the partition will slide down over the mounting foot and rest on the PVC spacer. The partition, while a little wobbly, will stand by itself.
- I. Wrap the 3P430 B-pillar Brackets around the front of the b-pillars and attach to the 3P344X and 3P345X brackets previously attached to the front of the partition. Leave the bolts loose. (See fig. 2)
- J. Center the partition in the car. Tighten the OEM seat mounting nuts to hold the partition central.
- K. Slide the rear end of the b-pillar brackets toward the center of the car until they are near flush with the outside edge of the partition tab and secure to the partition. The brackets can interfere with the filler wings if not flush. (See fig. 2)
- L. Check all components for proper fit and tighten all fasteners.

**V. Wing Installation**

- A. Strip the protective masking from the polycarbonate filler wings.
- B. Install the wings at each side of the partition using five 3X36 carriage bolts and 3X16Z nuts for each side. (See fig. 3)
- C. Adjust the wings in their mounting slots to clear the headliner and other interior components and tighten fasteners.



## VI. Optional Seat Protector Installation

- A. Place the seat protector against the back side of the partition with the bent portion angling forward under the back of the front seats.
- B. Adjust the height of the seat protector to the desired fit with the floor covering or Pro-gard Floor Pan. Attach with 3X36 carriage bolts and 3X16Z whiz nuts provided if the partition is pre-drilled. If not pre-drilled mark the appropriate locations and attach with self-drilling screws.

**Installation is now complete.**

