

INSTALLATION GUIDE
PB5311 PUSH BUMPER
HARDWARE KIT
CHEVROLET CAPRICE

Pro-gard[™]
PRODUCTS LLC.

STRONG | RELIABLE | SECURE

pro-gard.com
800.480.6680

THESE COMPONENTS ARE REQUIRED
TO ASSEMBLE THE PRO-GARD PUSH BUMPER HARDWARE KIT

I. Refer to the diagram on the last page of these instructions to verify all parts were received.

You will need the following tools:

- a. Ratchet with 13mm Socket
- b. 3/4" Socket
- c. 3/4" Open or box end wrench
- d. T15 Torx driver
- e. 7mm Nut driver

II. Please be sure to read all instructions before installation and do not fully tighten any of the bolts until all bolts have been hand started

1. Remove the vehicle's front fascia and plastic crush bumper to expose the metal crush bumper.

2. Remove the two (2) inner / upper most factory M8 bolts, and the two (2) outer / lower most factory M8 bolts from the bumper on each side, four (4) total. See Fig. 1

3. Cut slots in air dam in both lower corners to allow sides to fold out of the way when performing step 4. See Fig. 1

4. Using provided M8 bolts (2) (Clear Zinc) and 3/8" flat washers (1) (Yellow), and plastic spacers, install main bracket (8) on driver side of car and tighten. Install nut (6) and bolt (3) and tighten. See Fig. 2
Repeat for passenger side using bracket (7).

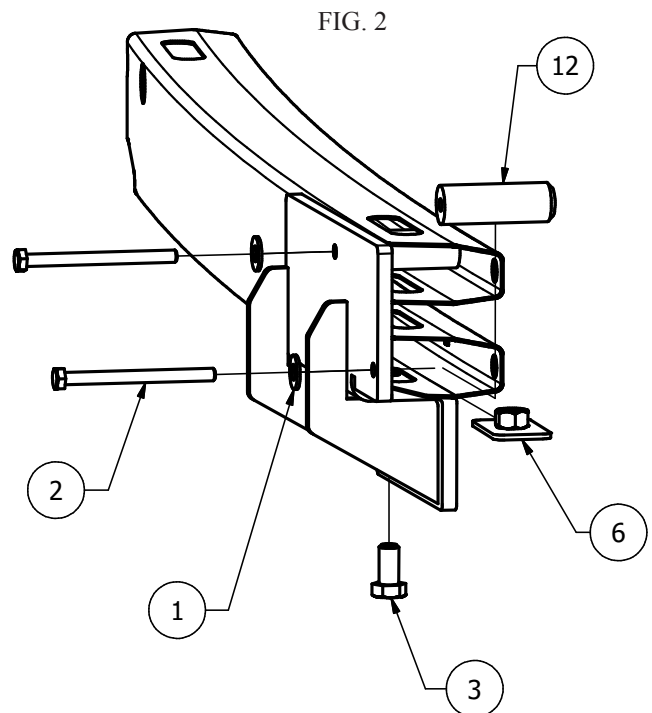
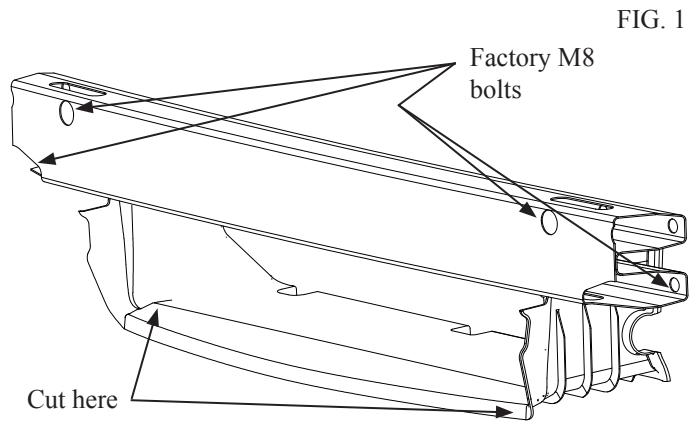

- Retrieve the vehicle's plastic crush bumper and trim to fit per Fig. 3.

FIG. 3

Front view of plastic
crush bumper

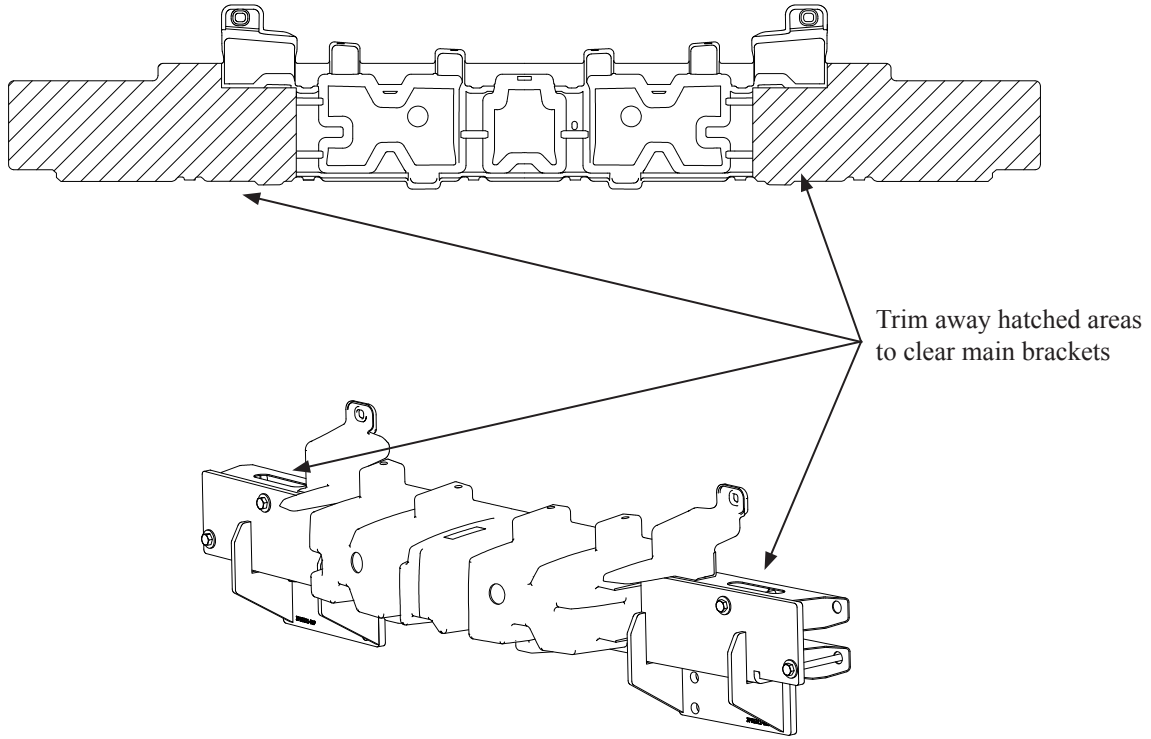

- Reassemble the plastic crush bumper to the metal bumper. Replace the facia to the front of the vehicle and mark where the lower brackets interfere with the lower grill opening. Cut the grill to clear the brackets. See Fig. 4.

FIG. 4

Trim away to fit around
main brackets

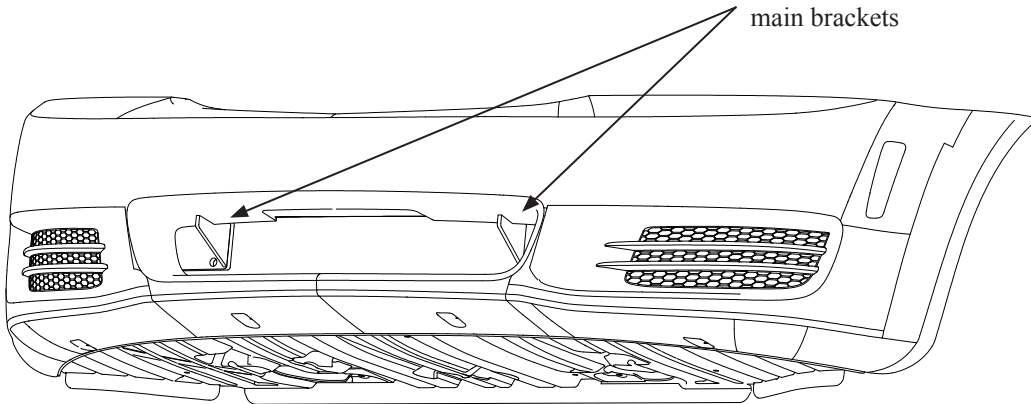

- Reassemble the facia to the vehicle.

FIG. 5

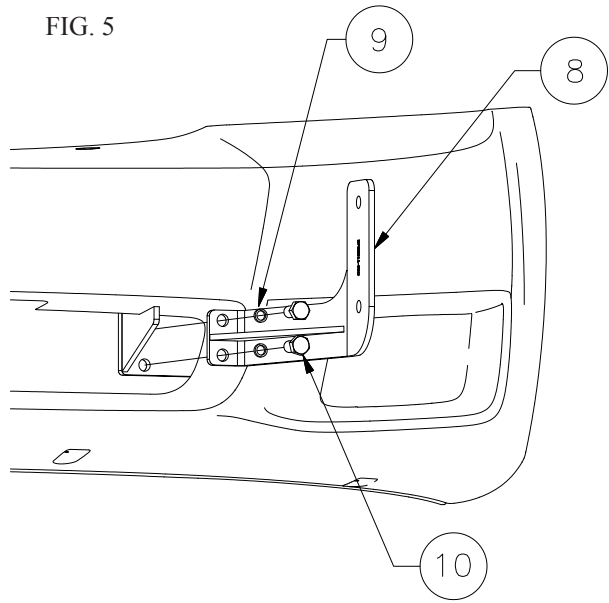

8. Install the lower bracket (8) on driver side of car, using 1/2-13 x 1-1/2" bolt (10), and 1/2" split ring washer (9). See Fig. 5 Repeat for passenger side using bracket (5).

9. Follow assembly instructions included with push bumper 3E1106 and assemble push bumper.
10. Install push bumper to the vehicle, using 1/2-13 x 1" bolt (3), 1/2" split ring washer (9) and 1/2-18 nut (11). See Fig. 6

3E1106
UNIVERSIAL FRONT PUSH BUMPER
ASSEMBLED SEPERATE

FIG. 6

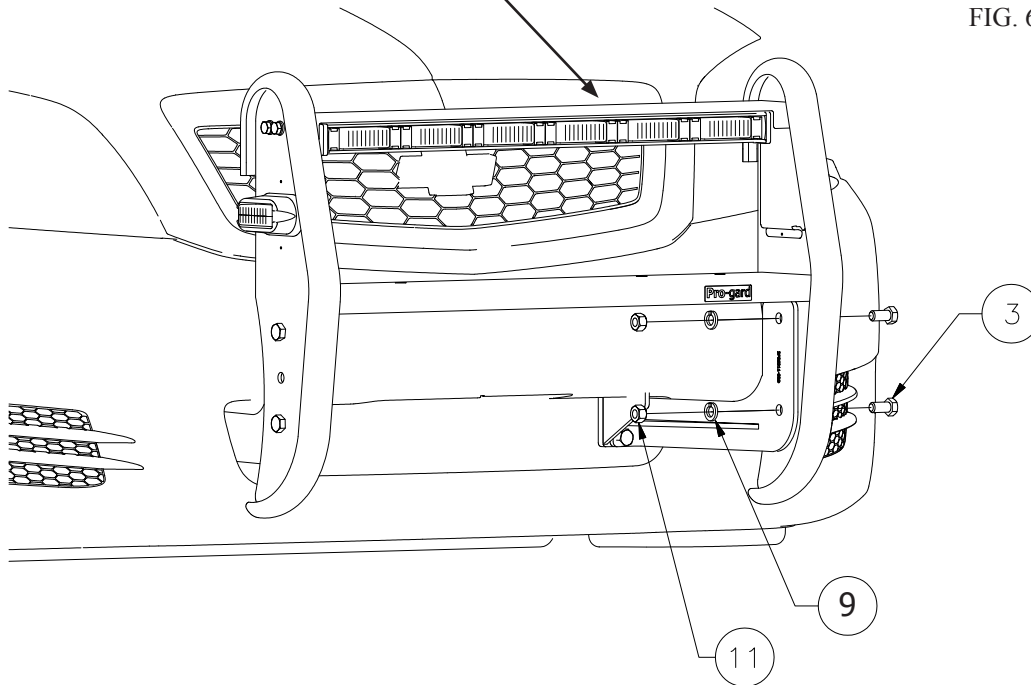

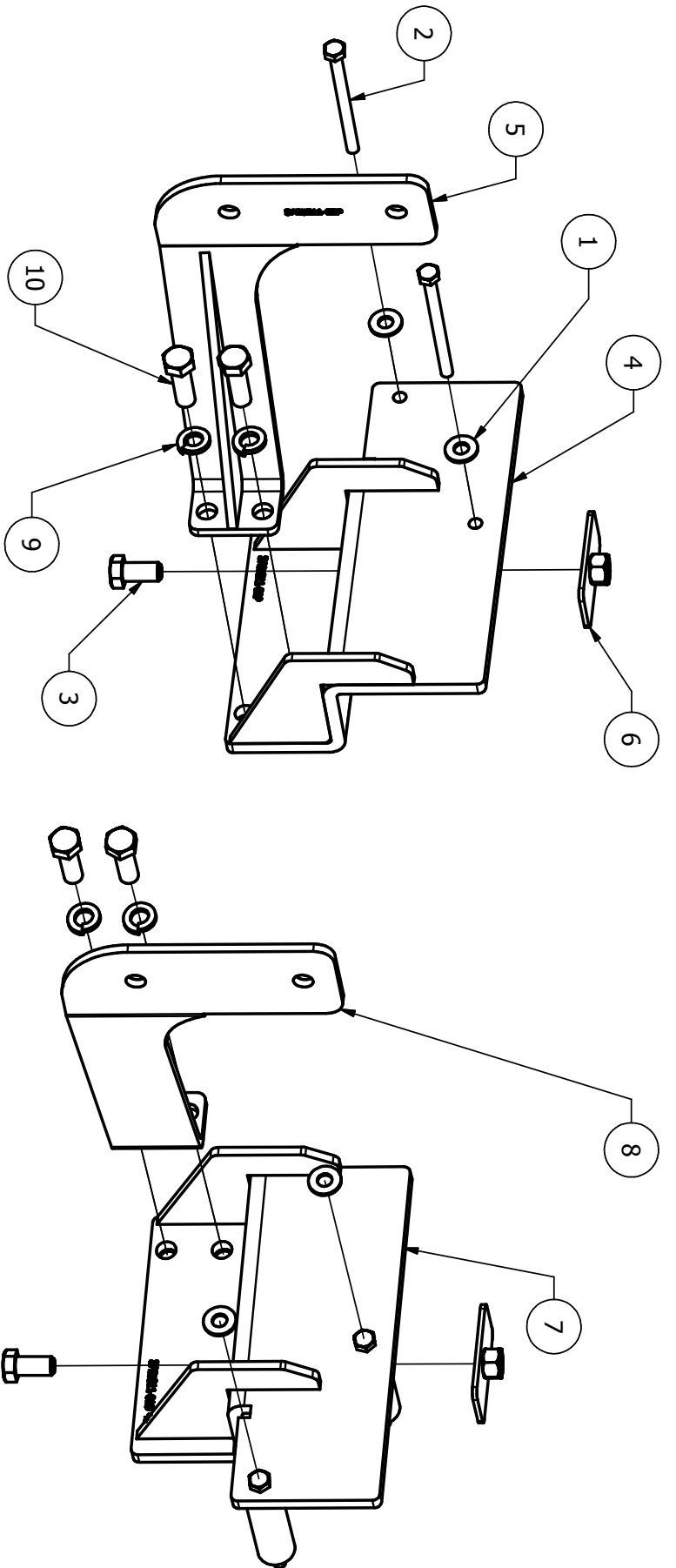

PARTS LIST

ITEM	QTY	PART NUMBER	DESCRIPTION
1	4	3X13	3/8 FLAT WSHR, YZ
2	4	3X213	M8-1.25x100mm HEX CAP SCREW ZINC
3	6	3X174	1/2-13 x 1" HHCS, GR8, BIK Zn/C
4	1	3PB5311-01P	MAIN_BRACKET_PASS
5	1	3PB5311-02P	LOWER-BRACKET_PASS
6	2	3PB5311-03	1/2-13 TAB BASE NUT
7	1	3PB5311-01D	MAIN_BRACKET_DRV
8	1	3PB5311-02D	LOWER-BRACKET_DRV
9	8	3X175	1/2" WSHR Split Lock, BIK Zn/C
10	4	3X212	1/2-13 x 1-1/2" HHCS, GR8, BIK Zn/C
11	4	3X176	1/2-13 NUT, GR8, BIK Zn/C
12	4	4PB5311-06	CRUSH BUMPER SPACER

