

**S56C06 & FP56C06
 INSTALLATION INSTRUCTIONS
 2006-2007 DODGE CHARGER
 FLOOR PAN & SEAT**

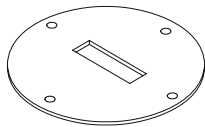

- **BE SURE TO CAREFULLY REVIEW ALL INSTRUCTIONS BEFORE INSTALLATION.**
- **BE SURE TO LOCATE ANY WIRES, FUEL TANKS, FUEL LINES, BRAKE LINES, ETC THAT MAY BE DAMAGED BEFORE DRILLING HOLES OR INSTALLING FASTENERS INTO THE VEHICLE.**
- **THIS SEAT AND FLOOR PAN IS DESIGNED TO BE USED IN '06-'07 DODGE CHARGER POLICE PACKAGE ONLY.**

NOTE: Carefully review the parts list below. If there are any missing parts, please call (317)-579-6680 and ask for "Customer Service" or circle the missing part on this sheet and fax to (317) 579-6681.



**Cover Plate
 4S6000C
 (2) Each**

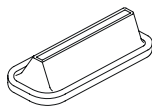

**Grommet
 3S5001
 (2) Each**



**#8x5/8" Phillips
 Truss Head
 3X72
 (8) Each**



**#10x1-1/2 Oval
 Phillips Head
 Self-Tapping
 Screw
 3X77 (7) Each**



**#10x5/8 Oval
 Phillips Head
 Self-Tapping
 Screw
 3X177 (2) Each**



**#10 Finish Washer
 3X78
 (9) Each**



**Floor Pan Grommet
 3S601
 (2) Each**



**Seat Location Tab
 3S5601
 (2) Each**

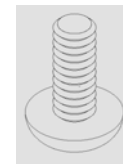

**1/4"-20 X 5/8" Truss
 Head Screw
 3X03 (4) Each**



**1/4"-20 ESNA Nylon
 Locknut
 3X17
 (4) Each**

I. Removing the OEM seat

- A. Begin by lifting the bottom cushion out from the rubber grommets in the floor (**See fig. 6**). Remove the seat belts by removing the OEM nuts from their mounting studs using a 18mm socket/wrench (**See fig. 1**). Do not remove the shoulder straps anchored at each side of the vehicle.
- B. Remove the OEM seat back cushion by removing two 18mm nuts from the lower mounting brackets near the seat belt mounting studs and pressing on the top of the spring locking tabs located on either side of the seat behind the top outer corners. A screwdriver can be used to unlock the spring tabs from above. (**See fig. 3 & 4**)
- C. With the seat removed, the OEM child restraint loops are exposed. Note the child restraint loops have been bent down toward the floor. This is necessary for the Pro-gard Seat to fit properly in position. Simply press down firmly on these bars until they resemble **Fig. 5**.

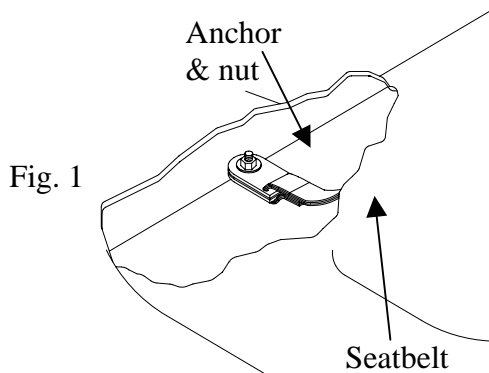

Fig. 2

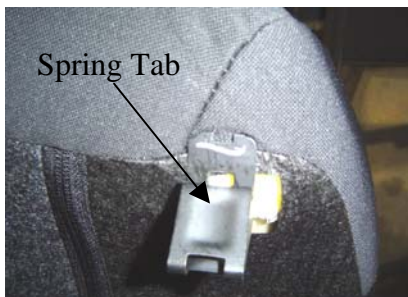

Fig. 3



Fig. 4



Fig. 5

II. Installing the Pro-gard ABS floor pan

- A. Before installing the floor pan, lift the front of the plastic C-pillar cover. Remove the Phillips screw securing the rear of the plastic B-pillar cover on both sides of the vehicle and lift to allow the floor pan to slide behind it and under the C-pillar cover.
- B. Next, install the floor pan making sure that there are no objects underneath. Note: The floor pan does not cover the OEM seat grommets (**See fig. 6 & 7**).

- C. Using the existing holes in the floor pan as a template, drill a 1 1/2" hole in each side of the floor. Insert the rubber drain grommets and put the floor pan in place. The plastic pillar covers can now be re-mounted.



Fig. 6

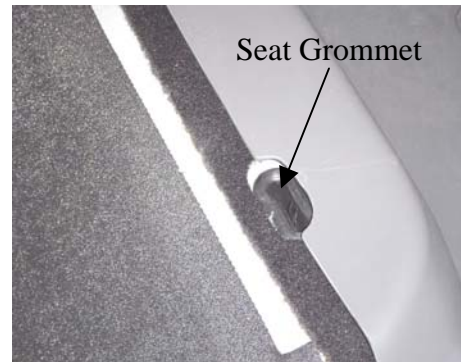

Fig. 7

III. Installing the Pro-gard ABS rear seat

- A. Before installing the Pro-gard seat, mount the seat locating tabs (3S5601) to the bottom of the ABS seat using the (3X03) screws and the 3X17 lock nuts (See **fig. 8**).

- B. **If installing a Pro-Cell divider, attach the (3P214) Divider Mounting Brackets as shown in Fig. 2, before installing the seat in the vehicle.**

- C. Place the seat in the vehicle. Make sure the locating tabs slide into the OEM seat grommets in the floor of vehicle (See **fig. 7 & 8**). The seat will lap over the back edge of the floor pan.

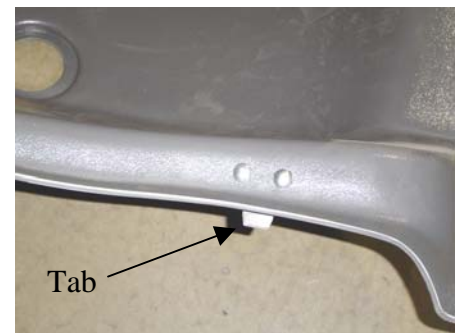

Fig. 8

- D. The seat has a seat belt relief notches at each side. Position the seat belt straps in each relief as shown in **Fig. 9**.

- E. Secure the outside front corners of the seat by using two 5/8" long (3X177) self-tapping screws and (3X78) finish washers at each end of the seat near the C-pillar trim using the pre-drilled holes provided in the seat. **NOTE: The gas tank is under the rear seat in this vehicle. Use pre-drilled locations only.**

- F. Use seven 1-1/2" long (3X77) self-tapping screws and (3X78) finish washers to secure the middle front (2) and top rear (5) of the seat using pre-drilled holes provided in the seat (See **fig. 10**).

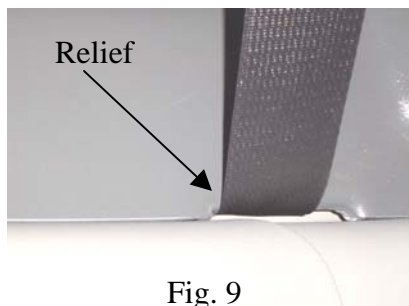
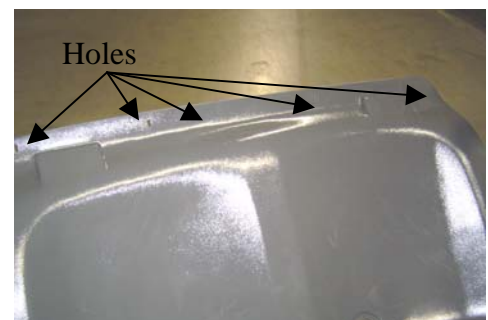

Fig. 9

Fig. 10



IV. Installing the OEM seatbelts with cover plates

- A. Insert the seat belts, mounting lugs first, through the rubber seat belt grommets. (See **figs. 11 & 12**)
- B. Pass the seat belt lug through the slot in the seat belt cover plate and install the rubber grommet into the slot of the cover plate. Slide the cover plate/grommet assembly up the belt towards the buckles.
- C. Insert the seat belt lug through the hole in the seat and reattach to OEM mounting stud with OEM nut. Radially orient and tighten with 18mm socket wrench.
- D. Slide cover plate and grommet assembly down the belt and into the recess in the seat. Radially orient and secure using the (3X72) Phillips truss head screws.

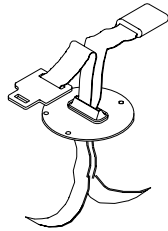

Fig. 11

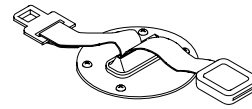

Fig. 12

IF YOU HAVE ANY QUESTIONS OR CONCERNS PLEASE CONTACT

PRO-GARD PRODUCTS, LLC
PHONE: 317-579-6680